

GBP204

GBP204A

HYDRAULIC INSTALLATION TOOL

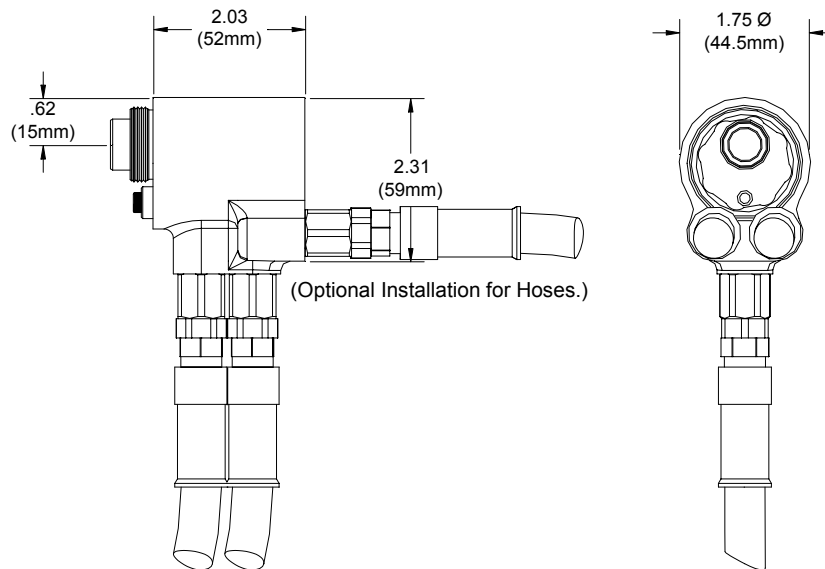

DESCRIPTION

Covered under Patent No. 5,371,933

The GBP204 and the GBP204A are hydraulic installation tools designed specifically for the efficient installation of a wide range of blind rivets and lockbolt fasteners thru 1/4" diameter. It weighs just over 3 lbs. and can be operated in any position with one hand. It has a .500 rivet setting stroke and a rated pull load of 5800 lbs.

The GBP204 installation tool operates on hydraulic pressure developed by the GBP940 Powerunit set at 5600 psi maximum PULL pressure and 2400 psi maximum RETURN pressure. The tool comes equipped with 12 feet of hydraulic hoses and couplings, electric switch and cord. The GBP204A installation tool operates on hydraulic pressure developed by the GBP910 Powerunit set at 5600 psi maximum PULL pressure and 2400 psi maximum RETURN pressure. The tool comes equipped with 12 feet of hydraulic hoses, swivels and couplings, air trigger and tube.

ALL GAGE BILT HYDRAULIC INSTALLATION TOOLS ARE COMPATIBLE WITH HUCK® POWERUNIT'S. NOSE ASSEMBLIES ARE NOT FURNISHED WITH THESE TOOLS AND MUST BE ORDERED SEPARATELY.

GAGE BILT

MADE IN U.S.A.

GAGE BILT Inc.

44766 Centre Court (586) 226-1500
Clinton Twp, MI 48038 (586) 226-1505 Fax
e-mail:solutions@gagebilt.com / www.gagebilt.com



GBP204 SELECTION CHART

FASTENER	DIA.	STANDARD	STRADDLE NOSE 1	LONG
NAS and GP® SHEAR/TENSION LOCKBOLTS BACB30TY BACB30UA BACB30TZ BACB30UB BACB30DY BACB30GX BACB30DX BACB30GP BACB30GO BACB30GY BACB30GW	5/32" 3/16" 1/4"	NAST05-204C-25OS NASS05-204C-25OS NAS06-204C-25OS NAS08-204C-25OS	NAST05-204C-30OS NASS05-204C-30OS NAS06-204C-30OS NAS08-204C-30OS	NAST05-204C-34OS NASS05-204C-34OS NAS06-204C-34OS NAS08-204C-34OS
MGP®	4mm 5mm	MGP4-204C-25OS MGP5-204C-25OS	MGP4-204C-30OS MGP5-204C-30OS	MGP4-204C-34OS MGP5-204C-34OS
LGP® LOCKBOLT LGPL2SC-V BACB30VM LGPL18SC-V BACB30XT LGPL4SC-V ABS0548 LGPL2SP-V BACB30VN LGPL4SP-V ASNA2392 LGPL8SC-V BACB30WD LGPL9SC-V BACB30WB LGPL9SP-V BACB30VY	5/32" 3/16" 1/4"	LGP05-204C-25OS LGP06-204C-25OS LGP08-204C-25OS	LGP05-204C-30OS LGP06-204C-30OS LGP08-204C-30OS	LGP05-204C-34OS LGP06-204C-34OS LGP08-204C-34OS
MLGP®	4mm 5mm 3/8"	MLGP4-204C-25OS MLGP5-204C-25OS MLGP6-204C-25OS	MLGP4-204C-30OS MLGP5-204C-30OS	MLGP4-204C-34OS MLGP5-204C-34OS MLGP6-204C-34OS
BLIND RIVET (SINGLE ACTION) WITH OR W/O DRIVE WASHER NAS1900 S & U SERIES	1/8" 5/32" 3/16" 1/4"	SMLS04-204D-27OS SMLS05-204D-27OS SMLS06-204D-27OS SMLS08-204D-27OS		SMLS04-204D-37OS SMLS05-204D-37OS SMLS06-204D-37OS SMLS08-204D-37OS
BLIND BOLT (SINGLE ACTION) WITH OR W/O DRIVE WASHER MS90353S & U / MS90354S & U MS21140S & U / MS21141S & U CR7000 SERIES, BACB30YY, YU, & YT	5/32" 3/16" 1/4"	SB05-204D-27OS SB06-204D-27OS SB08-204D-27OS		SB05-204D-37OS SB06-204D-37OS SB08-204D-37OS
BACR15FR/FP, BACR15GF/GK, NAS1900 S & U SERIES BLIND RIVET WITH DRIVE WASHER NAS9301-9312	1/4"	08MAX-204D-27OS		08MAX-204D-37OS
"A" CODE NAS1398A & NAS1399A	1/8" 5/32" 3/16" 1/4"	4A-204D-27OS 5A-204D-27OS 6A-204D-27OS SMLS08-204D-27OS		4A-204D-37OS 5A-204D-37OS 6A-204D-37OS SMLS08-204D-37OS
ASP® ASP 2, ASP PF, ASP 4 FF, ASP 2 F, ASP 2 LC	13/64" 17/64" 21/64"	ASP06-204D-27OS ASP08-204D-27OS ASP10-204D-27OS		ASP06-204D-37OS ASP08-204D-37OS ASP10-204D-37OS
NAS1719, NAS1720, NAS1721 & MBC®	1/8" 5/32" 3/16"	MBC04-204D-27OS MBC05-204D-27OS MBC06-204D-27OS		MBC04-204D-37OS MBC05-204D-37OS MBC06-204D-37OS
GROUND STUD, BACS53B	13/64" 17/64"	GS8-204D-32OS GS10-204D-32OS		GS8-204D-42OS GS10-204D-42OS

HUCK®, GP®, MGP®, LGP®, MLGP®, AND ASP® ARE REGISTERED TRADEMARKS OF ALCOA INC. MBC® IS A REGISTERED TRADEMARK OF CHERRY AEROSPACE.

GAGE BILT CERTIFIES THE GBP204 WILL INSTALL THE ABOVE FASTENERS

1) -30 STRADDLE NOSES ARE DESIGNED TO REACH OVER THE COLLAR.
*TO REDUCE STROKE TO .375 UNLOADING VALVE (206110) AND STROKE LIMITER (206112) ARE AVAILABLE.

10/11

NOTE: THE LAST 2 DIGITS OF THE NOSE ASSEMBLY REPRESENTS THE LENGTH THE NOSE ASSEMBLY EXTENDS FROM THE TOOL. (i.e. -25 = 2.5 inches)



GAGE BILT ALSO SUPPLIES PIN & COLLAR SWAGE INSPECTION GAGES TO CERTIFY CORRECT SWAGE INSTALLATION.



APPROXIMATE STANDARD DIMENSIONS

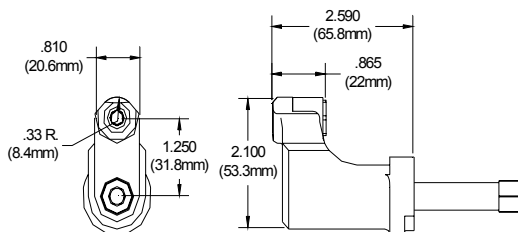

APPROXIMATE LONG DIMENSIONS

