

# GBP713C SERIES INSTALLATION TOOLS

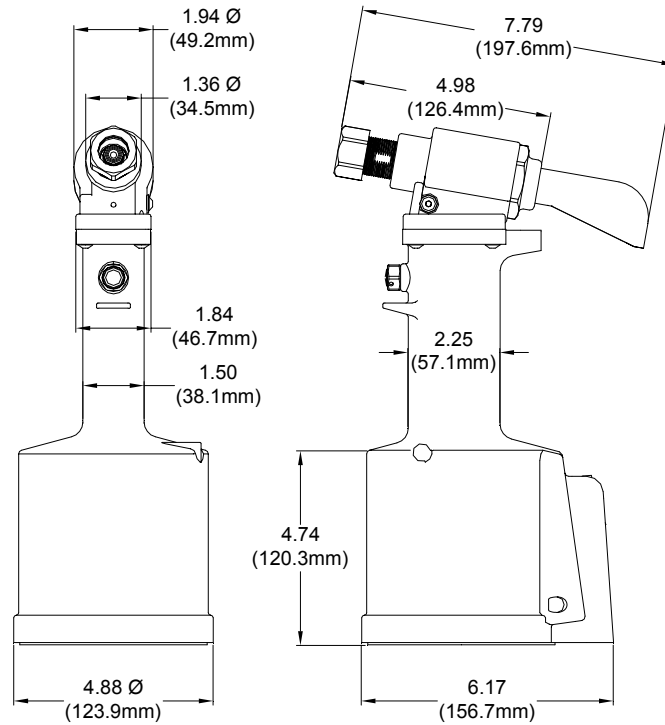

**GBP713C**

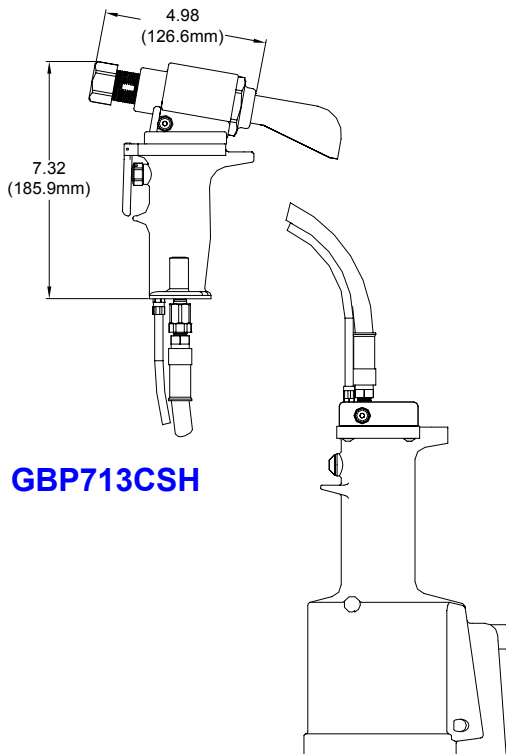

**GBP713CSH**

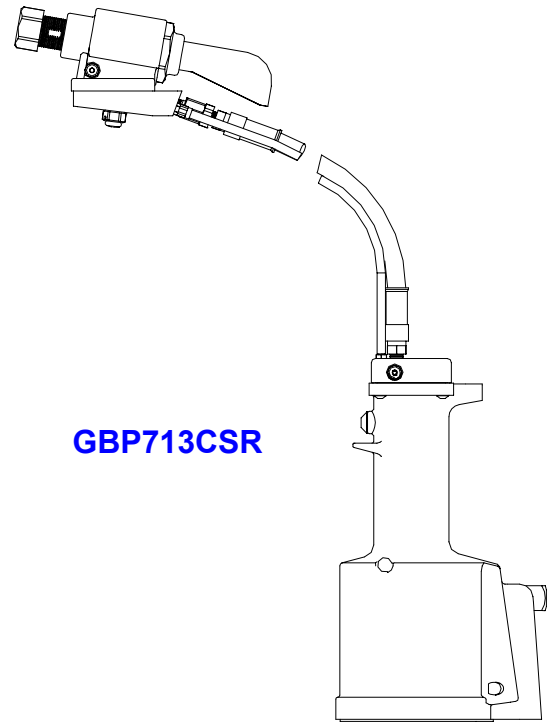

**GBP713CSR**

**GAGE BILT**  
MADE IN U.S.A.

**GAGE BILT PRODUCTS CORP.**

14500 Barber Drive (586) 771-7664  
Warren, Mi 48088 (586) 771-2665 Fax  
e-mail:solutions@gagebilt.com / www.gagebilt.com

### GBP713C

Stroke - .760"  
 Hand held weight - 6.50 lbs.  
 Entire tool weight - 6.50 lbs.  
 Pull load - 4,500



## GBP713C SERIES SELECTION CHART



### GBP713CSH

Stroke - .760"  
 Hand held weight - 2.50 lbs.  
 Entire tool weight - 7.50 lbs.  
 Pull load - 4,500

### GBP713CSR

Stroke - .760"  
 Hand held weight - 2.00 lbs.  
 Entire tool weight - 7.00 lbs.  
 Pull load - 4,500

### DESCRIPTION

The GBP713C series are pneumatic-hydraulic tools designed specifically for the efficient installation of a wide range of blind rivets. They can be operated in any position with one hand. They have a rated pull load of 4500 pounds with 90 psi air pressure at the air inlet.

The GBP713CSH and GBP713CSR riveters offer a unique "split" system providing the operator with an ergonomic tool with reduced hand held weight, as shown above.

The GBP713C series riveter operate on a wide range of air pressure, with 90 to 100 psi providing the maximum efficiency at 90 lbs air pressure, the GBP713C series does not exceed 85 db (A) and consumes 3 cfm at 20 cycles a minute.

The air inlet is provided with 1/4-18 female pipe threads to accept the users air hose fitting.

**NOSE ASSEMBLIES ARE NOT FURNISHED WITH TOOL AND MUST BE ORDERED SEPARATELY.**

FASTENER	DIA.	STRAIGHT		*OFFSET
COMMERCIAL LOCKBOLTS	3/16	LB06-722-20	LB06-722-60	
	1/4	LB08-722-20	LB08-722-60	
MULTIGRIP LOCKBOLTS	3/16	MG06-722-20	MG06-722-60	
	1/4	MG08-722-20	MG08-722-60	
"S" TYPE BLIND BOLT MS90353S & U, MS90354S & U MS21140S & U, MS21141S & U	5/32	SB05-752B-20	SB05-752B-45	SB05-752A-43OS
	3/16	SB05-752B-80		
		SB06-752B-20	SB06-752B-45	SB06-752A-43OS
	1/4	SB06-752B-80		
"U" TYPE BLIND BOLT WITH LOCKING WASHER MS90353U & MS90354U MS21140U & MS21141U	5/32	UBB05-752B-20	UBB05-752B-45	UBB05-752A-43OS
	3/16	UBB06-752B-20	UBB06-752B-45	UBB06-752A-43OS
		UBB08-713-20	UBB08-713-45	UBB08-204C-27OS, UBB08-204C-37OS
	1/4			
EN6122 & UAB130-EU EN6127 & UAB6127-EU EN6128 & UAB100-EU EN6129 & UABP-EU	1/8	UAB04-752B-20	UAB04-752B-45	UAB04-752A-43OS
	5/32	UAB568-713-21	UAB568-713-61	UAB05-752A-43OS
	3/16			UAB06-752A-43OS
	1/4			UAB08-204C-27OS, UAB08-204C-37OS
SINGLE ACTION BLIND RIVET NAS1919S NAS1921S	1/8	SMLS04-752B-20	SMLS04-752B-45	SMLS04-752A-43OS
	5/32	SMLS05-752B-20	SMLS05-752B-45	SMLS05-752A-43OS
	3/16	SMLS06-752B-20	SMLS06-752B-45	SMLS06-752A-43OS
	1/4	SMLS08-713-20		SMLS08-752A-43OS
UNIMATIO® SINGLE ACTION NAS1919U & NAS1921U BACR15FF/FR & BACR15GF/GK	1/8	UBR04-752B-20	UBR04-752B-45	UBR04-752A-43OS
	5/32	UBR05-752B-20	UBR05-752B-45	UBR05-752A-43OS
	3/16	UBR06-752B-20	UBR06-752B-45	UBR06-752A-43OS
	1/4	UBR08-713-20	UBR08-713-45	UBR08-752A-43OS
"A" CODE NAS1398A & NAS1399A	3/32	3A-352B-25		
	1/8	4A-752B-20	4A-752B-45	4A-752A-43OS
	5/32	5A-752B-20	5A-752B-45	5A-752A-43OS
	3/16	6A-752B-20	6A-752B-45	6A-752A-43OS
1/4	SMLS08-713-20		SMLS08-752A-43OS	
T RIVET	3/16	6T-352-21	6T-352-61	
	1/4	8T-352-21	8T-352-61	
PROTRUDING HEAD, MULTI-GRIP BLIND RIVETS	3/16	MGL06-752A-21	MGL06-752A-61	
	1/4	MGL08-752A-21	MGL08-752A-61	
MONOBOLT	3/16	MB06-752A-21	MB06-752A-61	
1/4	MB08-752A-21	MB08-752A-61		
CONTAINER BOLT(R 12) HLPP, HLPW, HLPE, HLPS HLPS & HLPSP	3/8	HT12-713-20		
TLR RIVET	1/4	8TLR-352-21	8TLR-352-61	
BACR15FR-FP & BACR15GF-GK NAS1919U & 1921U, NAS9301-9312	1/8	456MAX-751A-21	456MAX-751A-61	456MAX-752-42OS
	5/32			
	3/16			
ASP 2, ASP PF, ASP 4 FF, ASP 2 F, ASP 2 LC	13/64	ASP06-752B-20	ASP06-752B-45	ASP06-752A-43OS
	17/64	ASP08-752B-20	ASP08-752B-45	ASP08-752A-43OS
	21/64	ASP10-713-20	ASP10-713-45	ASP10-204C-27OS, ASP10-204C-37OS
NAS1719, NAS1720 NAS1721	1/8	MBC04-752B-20	MBC04-752B-45	MBC04-752A-43OS
	5/32	MBC05-752B-20	MBC05-752B-45	MBC05-752A-43OS
	3/16	MBC06-752B-20	MBC06-752B-45	MBC06-752A-43OS
GROUND STUD, M83454 BACSS3B	8/32	GS8-752B-20	GS8-752B-45	GS8-752A-43OS
	10/32	GS10-752B-20	GS10-752B-45	GS10-752A-43OS
OPEN END, CLOSED END, C'SUNK, PROTRUDING HEAD COMMERCIAL NAIL RIVETS	5/32	5N-352-21	5N-352-61	5N-751-43OS
	3/16	6N-352-21	6N-352-61	6N-751-43OS
	1/4	8CN-713-21	8CN-713-61	

THE GAGE BILT GBP713C IS APPROVED TO INSTALL THE ABOVE FASTENERS.

\*ALL OFFSET 204 SERIES NOSES REQUIRE 751204 ADAPTER & 713152 STROKE LIMITER

1) INSTALLS ALL THREE DIAMETERS.

2) ALUMINUM ONLY.

NOTE: THE LAST 2 DIGITS OF THE NOSE ASSEMBLY REPRESENTS THE LENGTH THE NOSE EXTENDS FROM THE TOOL. I.E. -20 = 2.0 INCHES