

GBP713D SERIES INSTALLATION TOOLS

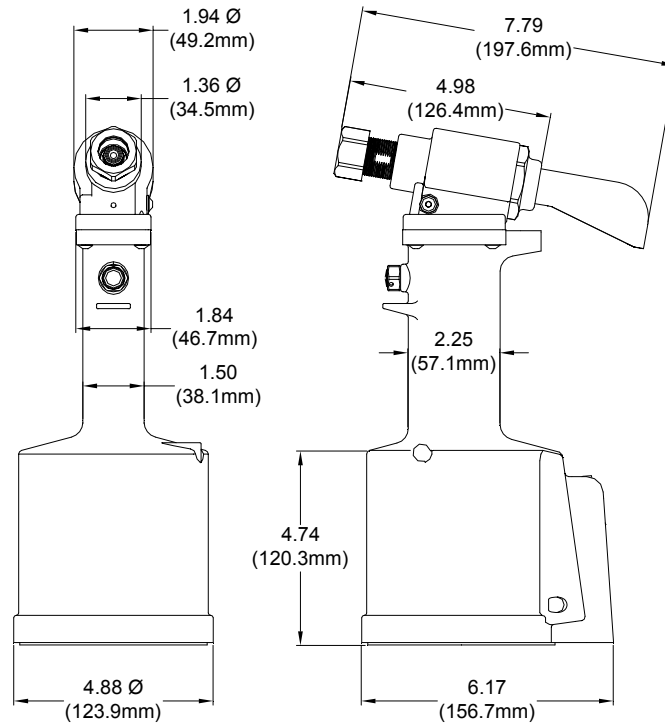

GBP713D

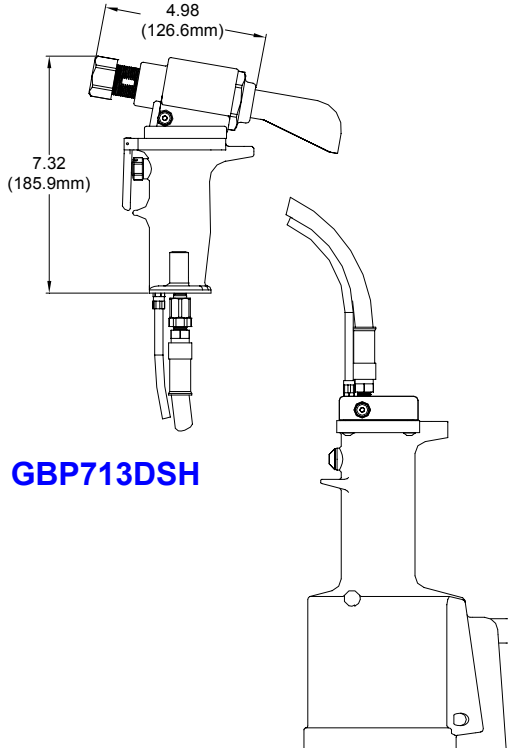

GBP713DSH

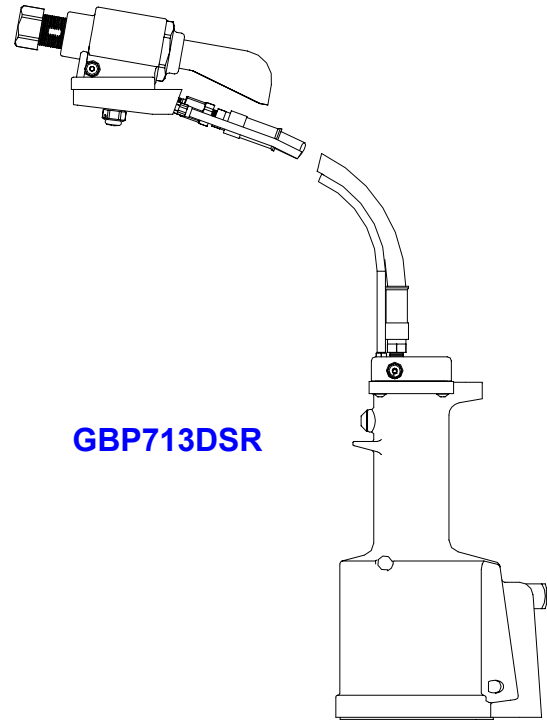

GBP713DSR

GAGE BILT
MADE IN U.S.A.

GAGE BILT Inc.
44766 Centre Court (586) 226-1500
Clinton Twp. MI 48038 (586) 226-1505 Fax
e-mail:solutions@gagebilt.com / www.gagebilt.com

GBP713D

Stroke - .760"

Hand held weight - 6.50 lbs.

Entire tool weight - 6.50 lbs.

Pull load - 4,500

GBP713DSH

Stroke - .760"

Hand held weight - 2.50 lbs.

Entire tool weight - 7.50 lbs.

Pull load - 4,500

GBP713DSR

Stroke - .760"

Hand held weight - 2.00 lbs.

Entire tool weight - 7.00 lbs.

Pull load - 4,500



GBP713D SERIES SELECTION CHART



FASTENER	DIA.	STRAIGHT		*RIGHT ANGLE	*OFFSET
COMMERCIAL LOCKBOLTS	3/16 1/4	LB06-722-20 LB08-722-20	LB06-722-60 LB08-722-60		
MULTIGRIP LOCKBOLTS	3/16 1/4	MG06-722-20 MG08-722-20	MG06-722-60 MG08-722-60		
BLIND BOLTS MS90353S & U & MS90354S & U MS21140S & U & MS21141S & U CR7000 SERIES BACB30YY, YU, & YT	5/32 3/16 1/4	SB05-752C-20 SB05-752C-80 SB06-752C-20 SB06-752C-80 SB08-713-20	SB05-752C-45 SB06-752C-45 SB06-752C-45 SB08-713-45	SB05-751B-54RA ₄ SB06-751B-54RA ₄ SB08-713-58RA _{3,4}	SB05-752A-43OS SB06-204D-27OS ₁ SB06-204D-37OS ₁ SB08-204D-27OS ₁ SB08-204D-37OS ₁
BLIND BOLTS MS90353 & MS90354 MS21140 & MS21141 "U" TYPE BLIND BOLT WITH DRIVE WASHER	5/32 3/16 1/4	UBB05-752B-20 UBB06-752B-20 UBB08-713-20	UBB05-752B-45 UBB06-752B-45 UBB08-713-45	UBB05-751B-54RA ₄ UBB06-751B-54RA ₄	UBB05-752A-43OS UBB06-752A-43OS UBB08-204D-27OS UBB08-204D-37OS
EN6122 & UAB130-EU EN6127 & UAB6127-EU EN6128 & UAB100-EU EN6129 & UABP-EU	1/8 5/32 3/16 1/4	UAB04-752B-20 UAB568-713-21	UAB04-752B-45 UAB568-713-61	UAB05-751B-54RA ₄ UAB06-751B-54RA ₄	UAB04-752A-43OS UAB05-752A-43OS UAB06-752A-43OS UAB08-204D-27OS UAB08-204D-37OS
SINGLE ACTION BLIND RIVET NAS1919S & U NAS1921S & U	1/8 5/32 3/16 1/4	SMLS04-752B-20 SMLS05-752B-20 SMLS06-752B-20 SMLS08-713-20	SMLS04-752B-45 SMLS05-752B-45 SMLS06-752B-45	SMLS04-751B-54RA ₄ SMLS05-751B-54RA ₄ SMLS06-751B-54RA ₄ SMLS08-713-58RA ₄	SMLS04-752A-43OS SMLS05-752A-43OS SMLS06-752A-43OS SMLS08-752A-43OS
"A" CODE NAS1398A & NAS1399A	3/32 1/8 5/32 3/16 1/4	3A-352B-25 4A-752B-20 5A-752B-20 6A-752B-20 SMLS08-713-20	4A-752B-45 5A-752B-45 6A-752B-45	3A-751B-54RA ₄ 4A-751B-54RA ₄ 5A-751B-54RA ₄ 6A-751B-54RA ₄	4A-752A-43OS 5A-752A-43OS 6A-752A-43OS SMLS08-204D-27OS
T RIVET	3/16 1/4	6T-352-21 8T-352-21	6T-352-61 8T-352-61		
PROTRUDING HEAD, MULTI-GRIP BLIND RIVETS	3/16 1/4	MGL06-752A-21 MGL08-752A-21	MGL06-752A-61 MGL08-752A-61		
MONOBOLT	3/16 1/4	MB06-752A-21 MB08-752A-21	MB06-752A-61 MB08-752A-61		
CONTAINER BOLT(R 12) HLPP, HLPF, HLPE, HLPS HLPSM & HLPSM	3/8	HT12-713-20			
TLR RIVET BACR15FR/FP, BACR15GF/GK, NAS1919 & NAS1921 "U" TYPE BLIND RIVET WITH DRIVE WASHER NAS9301-9312	1/4 1/8 5/32 3/16 1/4	8TLR-352-21 456MAX-751A-21, 456MAX-751A-61, 08MAX-752B-20	8TLR-352-61 456MAX-751A-61, 08MAX-752B-45	456MAX-751C-54RA ₄ 08MAX-713-58RA ₄	456MAX-731-43OS 08MAX-204D-27OS 08MAX-204D-37OS
ASP 2, ASP PF, ASP 4 FF, ASP 2 F, ASP 2 LC	13/64 17/64 21/64	SMLS04-752B-20 ASP08-752B-20 ASP10-713-20	ASP06-752B-45 ASP08-752B-45 ASP10-713-45	ASP06-751B-54RA ₄	ASP06-752A-43OS ASP08-752A-43OS ASP10-204D-27OS ASP10-204D-37OS
NAS1719, NAS1720 NAS1721	1/8 5/32 3/16	MBC04-752B-20 MBC05-752B-20 MBC06-752B-20	MBC04-752B-45 MBC05-752B-45 MBC06-752B-45	MBC04-751A-54RA ₄ MBC05-751A-54RA ₄ MBC06-751A-54RA ₄	MBC04-752A-43OS MBC05-752A-43OS MBC06-752A-43OS
GROUND STUD, M83454 BACSS3B	8/32 10/32	GS8-752B-20 GS10-752B-20	GS8-752B-45 GS10-752B-45	GS8-751B-54RA ₄ GS10-751A-54RA ₄	GS8-752A-43OS GS10-752A-43OS
OPEN END, CLOSED END, CSUNK, PROTRUDING HEAD COMMERCIAL NAIL RIVETS	5/32 3/16 1/4	5N-352-21 6N-352-21 8CN-713-21	5N-352-61 6N-352-61 8CN-713-61	5N-751B-54RA ₄ 6N-751B-54RA ₄	5N-751-43OS 6N-751-43OS

THE GAGE BILT GBP713D IS APPROVED TO INSTALL THE ABOVE FASTENERS.

*ALL OFFSET 204 SERIES NOSES REQUIRE 751204 ADAPTER & 713152 STROKE LIMITER.

1) INSTALLS 1/8", 5/32" AND 1/4" DIAMETERS.

2) ALUMINUM ONLY.

3) 105 P.S.I. REQUIRED FOR MS90353 & MS90354.

4) THESE NOSES REQUIRE 713153 STROKE LIMITER.

NOTE: THE LAST 2 DIGITS OF THE NOSE ASSEMBLY REPRESENTS
THE LENGTH THE NOSE EXTENDS FROM THE TOOL. I.E. -20 = 2.0 INCHES

DESCRIPTION

The GBP713D series are pneumatic-hydraulic tools designed specifically for the efficient installation of a wide range of blind rivets. They can be operated in any position with one hand. They have a rated pull load of 4500 pounds with 90 psi air pressure at the air inlet.

The GBP713DSH and GBP713DSR riveters offer a unique "split" system providing the operator with an ergonomic tool with reduced hand held weight, as shown above.

The GBP713D series riveter operate on a wide range of air pressure, with 90 to 100 psi providing the maximum efficiency at 90 lbs air pressure, the GBP713D series does not exceed 85 db (A) and consumes 3 cfm at 20 cycles a minute.

The air inlet is provided with 1/4-18 female pipe threads to accept the users air hose fitting.

NOSE ASSEMBLIES ARE NOT FURNISHED WITH TOOL AND MUST BE ORDERED SEPARATELY.