

GBP715C SERIES INSTALLATION TOOLS

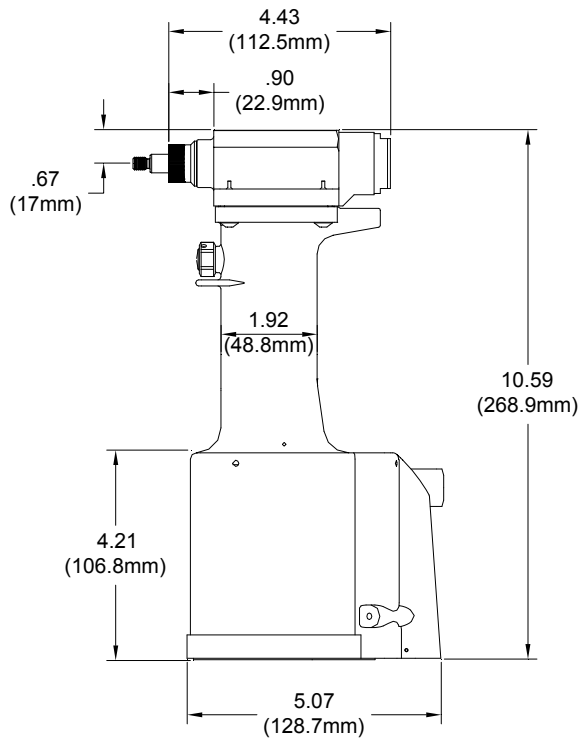

GBP715C

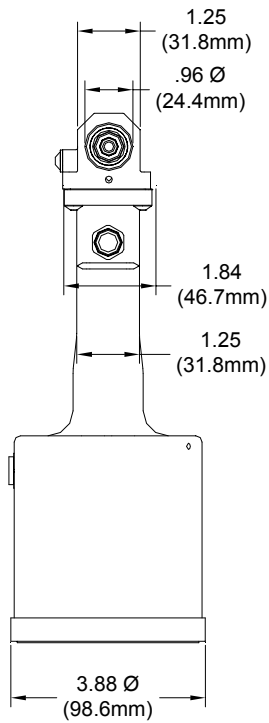
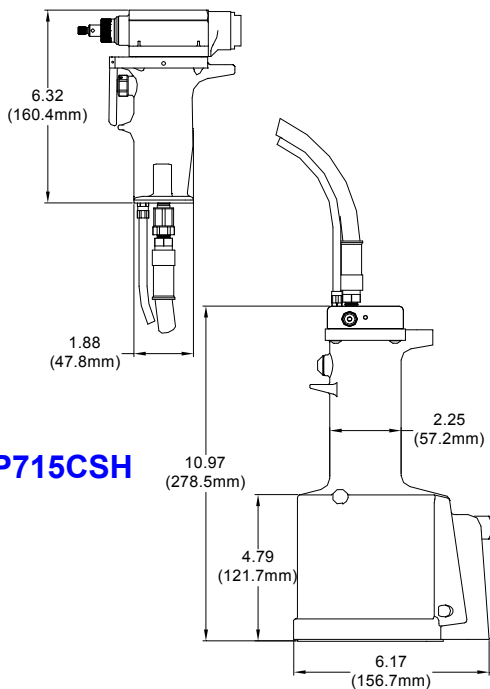

GBP715CSH

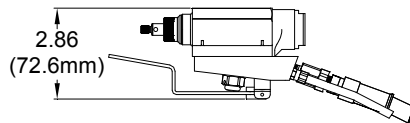

GBP715CSR

GAGE BILT
MADE IN U.S.A.

GAGE BILT PRODUCTS CORP.

44766 Centre Court (586) 226-1500
Clinton Twp. MI 48038 (586) 226-1505 Fax
e-mail: solutions@gagebilt.com / www.gagebilt.com

DESCRIPTION

The GBP715C series are pneumatic-hydraulic tools designed specifically for the efficient installation of a wide range of blind rivets. They can be operated in any position with one hand. They have a rated pull load of 1400 pounds with 90 psi air pressure at the air inlet.

The GBP715CSH and GBP715CSR riveters offer a unique “split” system providing the operator with an ergonomic tool with reduced hand held weight, as shown below.

The GBP715C series riveters operate on a wide range of air pressure, with 90 to 100 psi providing the maximum efficiency. At 90 lbs air pressure, the GBP715C series does not exceed 85 db (A) and consumes 3 cfm at 20 cycles a minute.

The air inlet is provided with 1/4-18 female pipe threads to accept the users air hose fitting.

NOSE ASSEMBLIES ARE NOT FURNISHED WITH TOOL AND MUST BE ORDERED SEPARATELY.

GBP715C

Stroke - 1.200"
 Hand held weight - 3.80 lbs.
 Entire tool weight - 3.80 lbs
 Pull load - 1,400

GBP715CSH

Stroke - 1.200"
 Hand held weight - 2.00 lbs.
 Entire tool weight - 7.25 lbs
 Pull load - 1,400

GBP715CSR

Stroke - 1.200"
 Hand held weight - 1.50 lbs.
 Entire tool weight - 6.75 lbs
 Pull load - 1,400



GBP715C SERIES SELECTION CHART



FASTENER	DIA.	STRAIGHT	RIGHT ANGLE	OFFSET
MS20600 SERIES MS/9SP/PT BACR15CC/CF/DA	3/32	3C-715B-43	3C-715-54RA	3C-715-40OS
	1/8	4C-715B-43	4C-715-54RA	4C-715-40OS
	5/32 ³	5C-715B-43	5C-715-54RA	5C-715-40OS
	3/16 ³	6C-715B-43	6C-715-54RA	6C-715-40OS
A' CODE NAS1398A NAS1399A	3/32	3A-715B-43	3A-715-54RA	3A-715-40OS
	1/8	4A-715B-43	4A-715-54RA	4A-715-40OS
	5/32 ³	5A-715B-43	5A-715-54RA	5A-715-40OS
	3/16 ⁴	6A-715B-43	6A-715-54RA	6A-715-40OS
SINGLE ACTION BLIND RIVET NAS1919S & U NAS1921S & U	1/8	SMLS04-715B-43	SMLS04-715-54RA	SMLS04-715A-40OS
	5/32 ³	SMLS05-715B-43	SMLS05-715-54RA	SMLS05-715A-40OS
	3/16 ³	SMLS06-715B-43	SMLS06-715-54RA	SMLS06-715A-40OS
BACR15FR/FP, BACR15GF/GK, NAS1919 & NAS1921 "U" TYPE BLIND RIVET WITH DRIVE WASHER NAS9301-9312	1/8			
	5/32 ³	456MAX-715-43 ²	456MAX-715A-54RA ²	456MAX-715-40OS ²
	3/16 ³			

THE GAGE BILT GBP715C TOOL IS APPROVED TO INSTALL THE ABOVE FASTENERS.

**ALL COUNTERSUNK 'C' NOSE ASSEMBLIES MAY USED TO INSTALL BOTH UNIVERSAL AND COUNTERSUNK HEAD RIVETS.
1) RIGHT ANGLE NOSE ASSEMBLIES MAY REQUIRE MORE THAN ONE PULL
2) INSTALLS 1/8, 5/32 & 3/16 DIAMETERS
3) ALUMINUM ONLY.
4) SELF-PLUGGING ALUMINUM ONLY.

NOTE: THE LAST 2 DIGITS OF THE NOSE ASSEMBLY REPRESENTS THE LENGTH THE NOSE EXTENDS FROM THE TOOL I.E. -20 = 2.0 INCHES