

# GBP752E SERIES INSTALLATION TOOLS

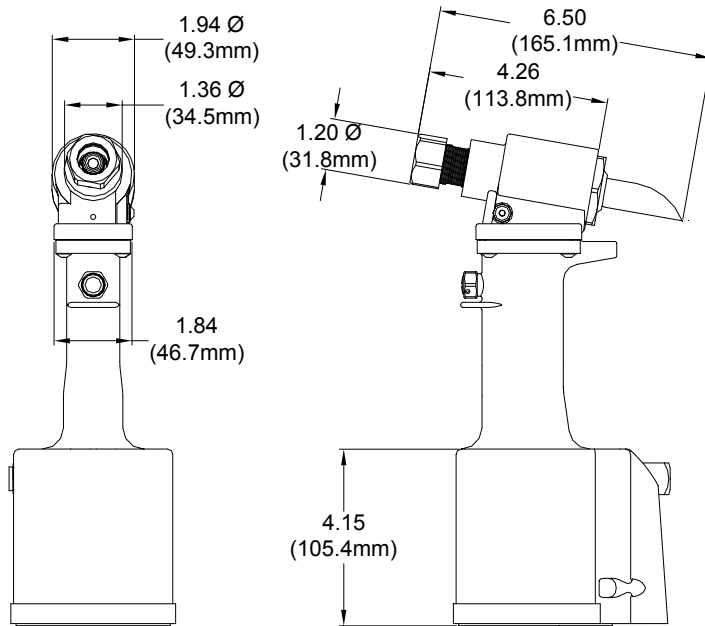

**GBP752E**

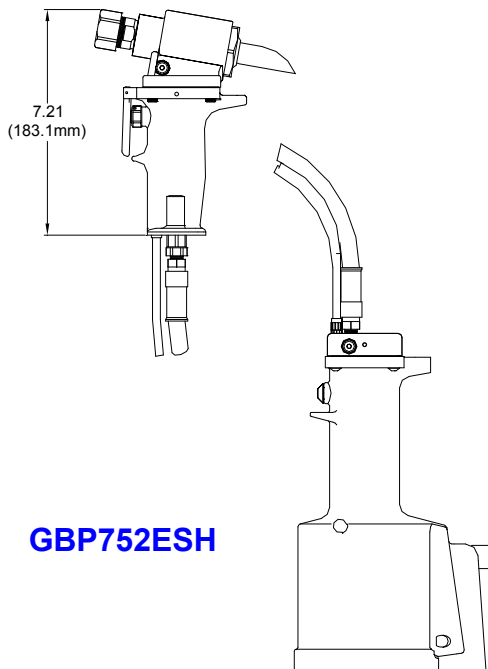

**GBP752ESH**

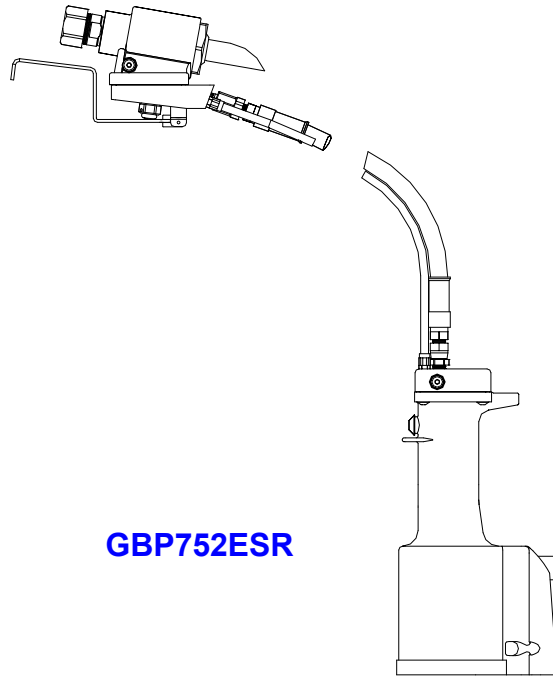

**GBP752ESR**

**GAGE BILT TOOLS ARE AVAILABLE WORLDWIDE  
E-MAIL US FOR A DISTRIBUTOR NEAR YOU**

**GAGE BILT**  
MADE IN U.S.A.

**GAGE BILT PRODUCTS CORP.**  
14500 Barber Drive (586) 771-7664  
Warren, Mi 48088 (586) 771-2665 Fax  
e-mail:solutions@gagebilt.com / www.gagebilt.com

**DESCRIPTION**

The GBP752E series are pneumatic-hydraulic tools designed specifically for the efficient installation of a wide range of blind rivets. They can be operated in any position with one hand. They have a rated pull load of 3800 pounds with 90 psi air pressure at the air inlet.

The GBP752ESH and GBP752ESR riveters offer a unique “split” system providing the operator with an ergonomic tool with reduced hand held weight, as shown below.

The GBP752E series riveters operate on a wide range of air pressure, with 90 to 100 psi providing the maximum efficiency. At 90 lbs air pressure, the GBP752E series does not exceed 85 db (A) and consumes 3 cfm at 20 cycles a minute.

The air inlet is provided with 1/4-18 female pipe threads to accept the users air hose fitting.

**NOSE ASSEMBLIES ARE NOT FURNISHED WITH TOOL AND MUST BE ORDERED SEPARATELY.**

**GBP752E**

Stroke - .500"  
 Hand held weight - 4.75 lbs.  
 Entire tool weight - 4.75 lbs  
 Pull load - 3,800

**GBP752ESH**

Stroke - .700"  
 Hand held weight - 2.50 lbs.  
 Entire tool weight - 7.50 lbs  
 Pull load - 3,800

**GBP752ESR**

Stroke - .500"  
 Hand held weight - 2.00 lbs.  
 Entire tool weight - 7.00 lbs  
 Pull load - 3,800

**GBP752E SERIES SELECTION CHART**



FASTENER	DIA.	STRAIGHT	*RIGHT ANGLE	**OFFSET	
COMMERCIAL LOCKBOLTS	3/16	LB06-722-20	LB06-722-60		
	1/4	LB08-722-20	LB08-722-60		
MULTIGRIP LOCKBOLTS	3/16	MG06-722-20	MG06-722-60		
	1/4	MG08-722-20	MG08-722-60		
"S" TYPE BLIND BOLT MS90353S & MS90354S MS21140S & MS21141S	5/32	SB05-752B-20	SB05-752B-45	SB05-751B-54RA	SB05-752A-43OS
	3/16	SB05-752B-80			
		SB06-752B-20	SB06-752B-45	SB06-751B-54RA	SB06-752A-43OS
"U" TYPE BLIND BOLT WITH LOCKING WASHER MS90353U & MS90354U MS21140U & MS21141U	5/32	UBB05-752B-20	UBB05-752B-45	UBB05-751B-54RA	UBB05-752A-43OS
	3/16	UBB05-752B-80			
		UBB06-752B-20	UBB06-752B-45	UBB06-751B-54RA	UBB06-752A-43OS
		UBB06-752B-80			
EN6122 & UAB130-EU EN6127 & UAB6127-EU EN6128 & UAB100-EU EN6129 & UABP-EU	5/32	UAB568-713-21	UAB568-713-61	UAB05-751B-54RA	UAB05-752A-43OS
	3/16			UAB06-751B-54RA	UAB06-752A-43OS
SINGLE ACTION BLIND RIVET NAS1919S & NAS1921S	1/8	SMLS04-752B-20	SMLS04-752B-45	SMLS04-751B-54RA	SMLS04-752A-43OS
	5/32	SMLS05-752B-20	SMLS05-752B-45	SMLS05-751B-54RA	SMLS05-752A-43OS
	3/16	SMLS06-752B-20	SMLS06-752B-45	SMLS06-751B-54RA	SMLS06-752A-43OS
	1/4	SMLS08-713-20	SMLS08-713-45		SMLS08-752A-43OS
UNIMATIC® SINGLE ACTION NAS1919U & NAS1921U BACR15FP/FR & BACR15GF/GK	1/8	UBR04-752B-20	UBR04-752B-45	UBR04-751B-54RA	UBR04-752A-43OS
	5/32	UBR05-752B-20	UBR05-752B-45	UBR05-751B-54RA	UBR05-752A-43OS
	3/16	UBR06-752B-20	UBR06-752B-45	UBR06-751B-54RA	UBR06-752A-43OS
	1/4	UBR08-713-20	UBR08-713-45		UBR08-752A-43OS
"A" CODE NAS1398A & NAS1399A	3/32	3A-352B-25		3A-751B-54RA	
	1/8	4A-752B-20	4A-752B-45	4A-751B-54RA	4A-752A-43OS
	5/32	5A-752B-20	5A-752B-45	5A-751B-54RA	5A-752A-43OS
	3/16	6A-752B-20	6A-752B-45	6A-751B-54RA	6A-752A-43OS
1/4	SMLS08-713-20			SMLS08-752A-43OS	
NUT PLATE RIVETS CCR244/264/274 BACR15DR MS20800	3/32	3NP-352-21	3NP-352-61	3NP-751B-54RA	3NP-751-43OS
	1/8	5N-352-21	5N-352-61	5N-751B-54RA	5N-751-43OS
BACR15FR/FR, BACR15GF/GK, NAS1919U & 1921U, NAS9301-9312	1/8	2 456MAX-751A-21	2 456MAX-751A-61	2 456MAX-751C-54RA	2 456MAX-752-42OS
	5/32				
	3/16				
1/4	08MAX-752B-20	08MAX-752B-45		**08MAX-204C-27OS    **08MAX-204C-37OS	
ASP 2, ASP PF, ASP 4 FF, ASP 2 F, ASP 2 LC	13/64	ASP06-752B-20	ASP06-752B-45	ASP06-751B-54RA	ASP06-752A-43OS
	17/64	ASP08-752B-20	ASP08-752B-45		ASP08-752A-43OS
NAS1719, NAS1720 NAS1721	1/8	MBC04-752B-20	MBC04-752B-45	MBC04-751A-54RA	MBC04-752A-43OS
	5/32	MBC05-752B-20	MBC05-752B-45	MBC05-751A-54RA	MBC05-752A-43OS
	3/16	MBC06-752B-20	MBC06-752B-45	MBC06-751A-54RA	MBC06-752A-43OS
GROUND STUD, M83454 & BACSS3B	8/32	GS8-752B-20	GS8-752B-45	GS8-751B-54RA	GS8-752A-43OS
	10/32	GS10-752B-20	GS10-752B-45	GS10-752A-54RA	GS10-752A-43OS
OPEN END, CLOSED END, C'SUNK, PROTRUDING HEAD COMMERCIAL NAIL RIVETS	3/32	3N-352-21	3N-352-61	3N-751B-54RA	3N-751-43OS
	1/8	4N-352-21	4N-352-61	4N-751B-54RA	4N-751-43OS
	5/32	5N-352-21	5N-352-61	5N-751B-54RA	5N-751-43OS
	3/16	6N-352-21	6N-352-61	6N-751B-54RA	6N-751-43OS

THE GAGE BILT GBP752E SERIES TOOLS ARE APPROVED TO INSTALL THE ABOVE FASTENERS

*ALL RIGHT ANGLE NOSES REQUIRE 752140 STROKE LIMITER.
**ALL OFFSET 204 SERIES NOSES REQUIRE 751204 ADAPTER.
1) RIGHT ANGLE NOSE ASSEMBLY'S MAY REQUIRE MORE THAN ONE PULL.
2) INSTALLS 1/8, 5/32 & 3/16 DIAMETERS
3) INSTALLS 5/32 & 3/16 DIAMETERS

NOTE: THE LAST 2 DIGITS OF THE NOSE ASSEMBLY REPRESENTS THE LENGTH THE NOSE EXTENDS FROM THE TOOL I.E. -20 = 2.0 INCHES