

GAGE BILT... solutions

Introducing the GBP722TCK... Trailer and Cab Kit

Choose GAGE BILTS' blind rivet and lockbolt installation kit designed especially for Truck and Trailer OEM's. The GBP722TCK can be configured to meet your needs, whether you're fixing Wabash, Great Dane, Peterbilt, Kenworth or any other brand trailer or truck. The kit includes nose assemblies to pull your fasteners, and at the heart of the system is our heavy-duty GBP722 installation tool. All of this is conveniently stored in a metal tool case.



The GBP722TCK kit comes with a nose and 2 tips to install 3/16" and 1/4" structural blind rivets in any material, a catcher bag for pintails, a 3/16" nose for the stainless steel grill bolt, and a 3/16" & 1/4" Magna-Grip® nose for the hood and cab. If additional noses are needed please consult Gage Bilt.



GAGE BILT
MADE IN U.S.A.

GAGE BILT PRODUCTS CORP.
44766 Centre Court (586) 226-1500
Clinton Twp. MI 48038 (586) 226-1505 Fax
e-mail:solutions@gagebilt.com / www.gagebilt.com

GBP722TCK

BLIND RIVETS

(2 PULLS REQUIRED FOR MOST APPLICATIONS)

	3/16"	ALUMINUM, STEEL OR STAINLESS STEEL MAGNA-LOK® BLIND RIVET	MGLC68-752A-21 (USE 10248-4 NOSE TIP)
	1/4"	ALUMINUM, STEEL OR STAINLESS STEEL MAGNA-LOK® BLIND RIVET	MGLC68-752A-21 (USE 10211-1 NOSE TIP)

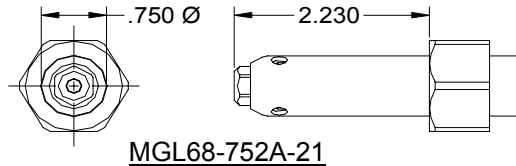

LOCKBOLTS

	3/16"	STAINLESS STEEL C6L	LB06-722-20
	3/16"	STEEL C6L	
	3/16"	ALUMINUM C6L	
	3/16"	STEEL MAGNA-GRIP®	MG06-722-20
	3/16"	ALUMINUM MAGNA-GRIP®	
	1/4"	STEEL MAGNA-GRIP®	MG08-722-20
	1/4"	ALUMINUM MAGNA-GRIP®	

*NOSES LISTED PROTRUDE 2 INCHES FROM THE TOOL. LONGER NOSES ARE AVAILABLE.

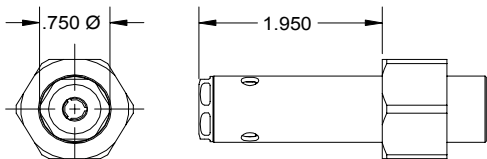

LB06-722-20

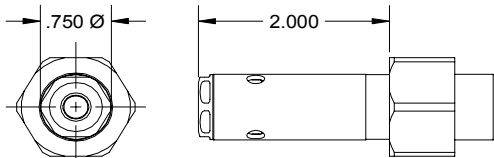

MG08-722-20

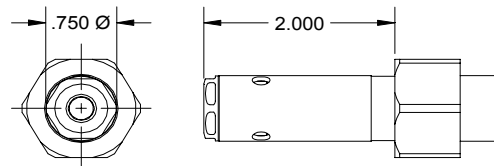

MG06-722-20