

GBP204

GBP204A

HYDRAULIC INSTALLATION TOOL

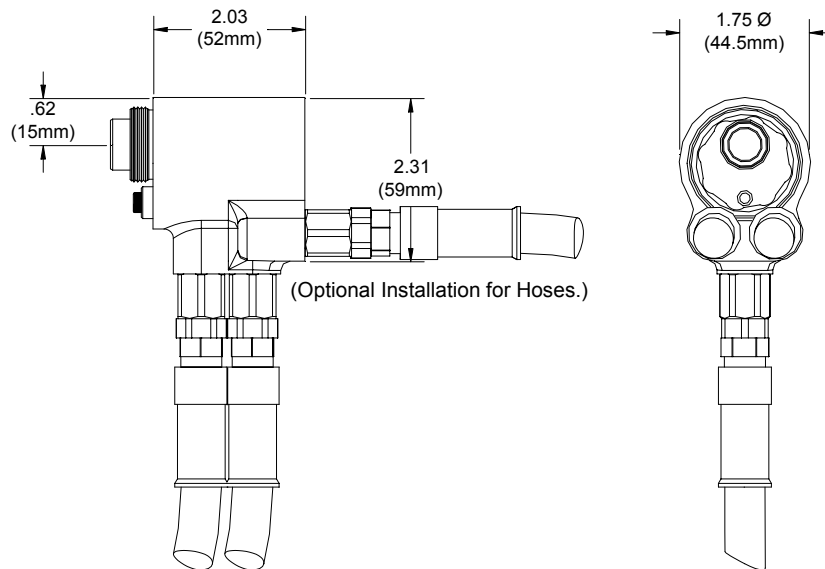

DESCRIPTION

Covered under Patent No. 5,371,933

The GBP204 and the GBP204A are hydraulic installation tools designed specifically for the efficient installation of a wide range of blind rivets and lockbolt fasteners thru 1/4" diameter. It weighs just over 3 lbs. and can be operated in any position with one hand. It has a .500 rivet setting stroke and a rated pull load of 5800 lbs.

The GBP204 installation tool operates on hydraulic pressure developed by the GBP940 Powerunit set at 5600 psi maximum PULL pressure and 2400 psi maximum RETURN pressure. The tool comes equipped with 12 feet of hydraulic hoses and couplings, electric switch and cord. The GBP204A installation tool operates on hydraulic pressure developed by the GBP910 Powerunit set at 5600 psi maximum PULL pressure and 2400 psi maximum RETURN pressure. The tool comes equipped with 12 feet of hydraulic hoses, swivels and couplings, air trigger and tube.

ALL GBP HYDRAULIC INSTALLATION TOOLS ARE COMPATIBLE WITH HUCK POWERUNIT'S. NOSE ASSEMBLIES ARE NOT FURNISHED WITH THESE TOOLS AND MUST BE ORDERED SEPARATELY.

GAGE BILT

MADE IN U.S.A.

GAGE BILT PRODUCTS CORP.

14500 Barber Drive

(586) 771-7664

Warren, Mi 48088

(586) 771-2665 Fax

e-mail: solutions@gagebilt.com / www.gagebilt.com



GBP204 SELECTION CHART

FASTENER	DIA.	STANDARD	STRADDLE NOSE 1	LONG
LOCKBOLT, NAS SHEAR PULL TYPE, NAS TENSION PULL TYPE, NASS = SHEAR & GP NAST = TENSION	5/32"	NAST05-204B-25OS	NAST05-204B-30OS	NAST05-204B-34OS
	3/16"	NASS05-204B-25OS	NASS05-204B-30OS	NASS05-204B-34OS
	1/4"	NAS06-204B-25OS	NAS06-204B-30OS	NAS06-204B-34OS
MGP	4mm	MGP4-204B-25OS	MGP4-204B-30OS	MGP4-204B-34OS
	5mm	MGP5-204B-25OS	MGP5-204B-30OS	MGP5-204B-34OS
	5/32"	LGP05-204B-25OS	LGP05-204B-30OS	LGP05-204B-34OS
Lightw eight Groove Proportion LOCKBOLT	3/16"	LGP06-204B-25OS	LGP06-204B-30OS	LGP06-204B-34OS
	1/4"	LGP08-204B-25OS	LGP08-204B-30OS	LGP08-204B-34OS
	4mm	MLGP4-204B-25OS	MLGP4-204B-30OS	MLGP4-204B-34OS
MLGP	5mm	MLGP5-204B-25OS	MLGP5-204B-30OS	MLGP5-204B-34OS
	1/8"	SMLS04-204C-27OS		SMLS04-204C-37OS
SINGLE ACTION BLIND RIVET NAS1919S & U, NAS1921S & U	5/32"	SMLS05-204C-27OS		SMLS05-204C-37OS
	3/16"	SMLS06-204C-27OS		SMLS06-204C-37OS
	1/4"	SMLS08-204C-27OS		SMLS08-204C-37OS
	5/32"	SB05-204C-27OS		SB05-204C-37OS
SINGLE ACTION BLIND BOLT MS90353S & U, MS90354S & U MS12140S & U, MS21141S & U	3/16"	SB06-204C-27OS		SB06-204C-37OS
	1/4"	SB08-204C-27OS		SB08-204C-37OS
	1/4"	08MAX-204C-27OS		08MAX-204C-37OS
"A" CODE NAS1398A & NAS1399A	1/8"	4A-204C-27OS		4A-204C-37OS
	5/32"	5A-204C-27OS		5A-204C-37OS
	3/16"	6A-204C-27OS		6A-204C-37OS
	1/4"	SMLS08-204C-27OS		SMLS08-204C-37OS
ASP 2, ASP PF, ASP 4 FF, ASP 2 F, ASP 2 LC	13/64"	ASP06-204C-27OS		ASP06-204C-37OS
	17/64"	ASP08-204C-27OS		ASP08-204C-37OS
	21/64"	ASP10-204C-27OS		ASP10-204C-37OS
NAS1719, NAS1720, NAS1721 & MBC	1/8"	MBC04-204C-27OS		MBC04-204C-37OS
	5/32"	MBC05-204C-27OS		MBC05-204C-37OS
	3/16"	MBC06-204C-27OS		MBC06-204C-37OS
GROUND STUD, BACS53B	13/64"	GS8-204C-32OS		GS8-204C-42OS
	17/64"	GS10-204C-32OS		GS10-204C-42OS

THE GBP204 TOOL IS APPROVED TO INSTALL THE ABOVE FASTENERS.

1) -30 STRADDLE NOSES ARE DESIGNED TO REACH OVER THE COLLAR.

*TO REDUCE STROKE TO .375 UNLOADING VALVE (206110) AND STROKE LIMITER (206112) ARE AVAILABLE.

NOTE: THE LAST 2 DIGITS OF THE NOSE ASSEMBLY REPRESENTS THE LENGTH THE NOSE ASSEMBLY EXTENDS FROM THE TOOL. (I.e. -25 = 2.5 inches)



GAGE BILT ALSO SUPPLIES PIN & COLLAR SWAGE INSPECTION GAGES TO CERTIFY CORRECT SWAGE INSTALLATION.



APPROXIMATE STANDARD DIMENSIONS

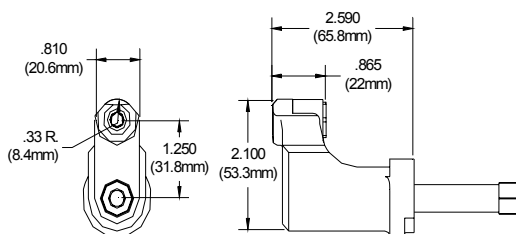

APPROXIMATE LONG DIMENSIONS

