

NOSE ASSEMBLY DATA SHEET

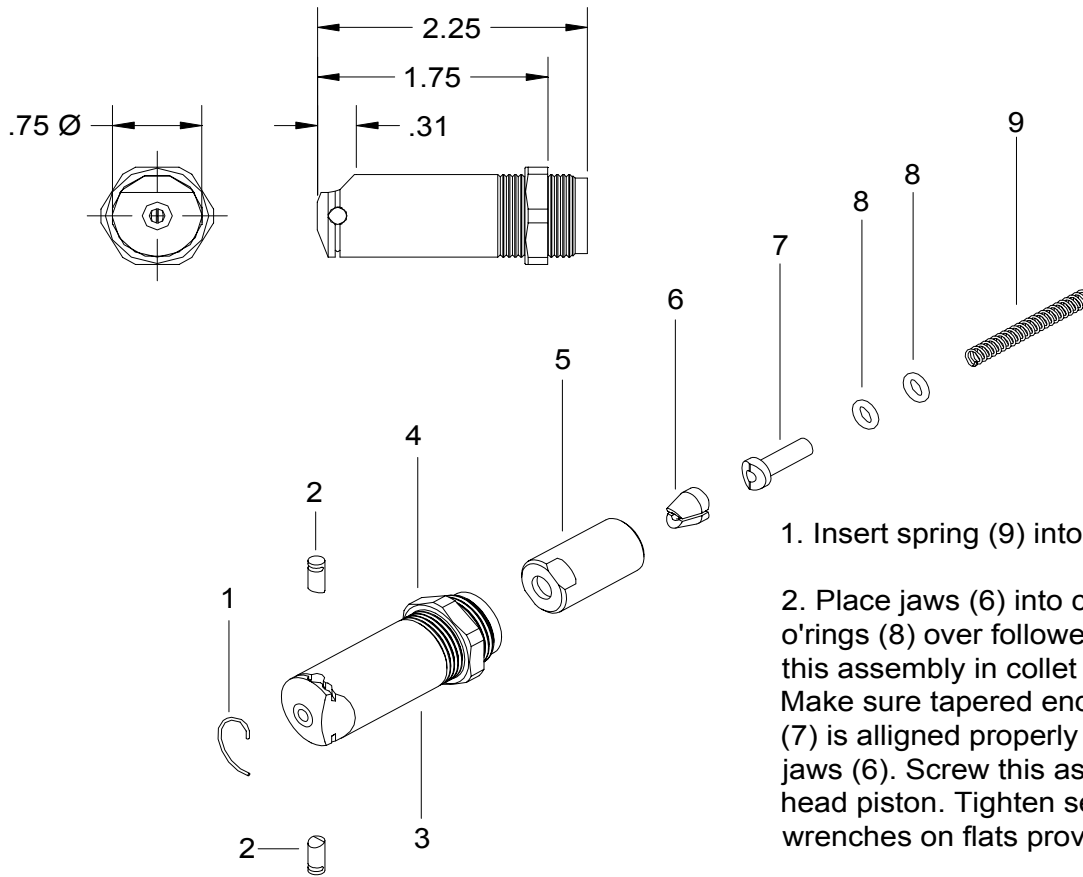

1. Insert spring (9) into head piston on tool.

2. Place jaws (6) into collet (5). Place o-rings (8) over follower (7) and place this assembly in collet against jaws. Make sure tapered end of jaw follower (7) is aligned properly in bevel in back of jaws (6). Screw this assembly onto end of head piston. Tighten securely, using wrenches on flats provided.

3. Thread outer sleeve (3), which contains jam nut (4), snugly into end of head cylinder. Tighten jam nut (4) securely.

KEEP NOSE ASSEMBLIES CLEAN



5/99 Rev. 3/12

GAGE BILT
MADE IN U.S.A.

GAGE BILT Inc.

44766 Centre Court (586) 226-1500
Clinton Twp. MI 48038 (586) 226-1505 Fax
e-mail: solutions@gagebilt.com / www.gagebilt.com

Type:		Fastener:		Recommended Tool:
Non Self-Releasing 1/8", 5/32" & 3/16" Ø		CHERRYMAX®, CHERRYMAX® 'AB', MBC® LOCK CREATOR BACR15FR/FP, BACR15GF/GK		
Ref. No.	Qty.	Description		456MAX-701-17
1	1	Retaining Ring		70101
2	2	Stem Stop		70102
3	1	Sleeve		70103
4	1	Jam Nut		70104
5	1	Collet		70105
6	1	Jaw Set (2 pcs.)		30513
7	1	Follower		40506
8	2	O'Ring		400774
9	1	Spring		70109