

EXTENSION ASSEMBLY DATA SHEET

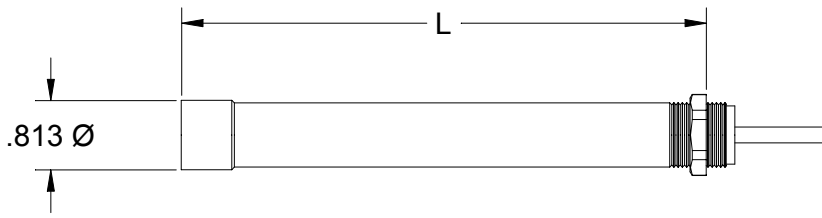

| Part Number | L |
|-------------|-----|
| *704002 | 2" |
| *704004 | 4" |
| *704006 | 6" |
| *704006-2 | 12" |

These extensions help reach many restricted areas by increasing the overall length of the nose assembly. They fit directly on the GB704 Installation Tool and will accept any nose assembly for Cherrymax® and High Clinch rivets.

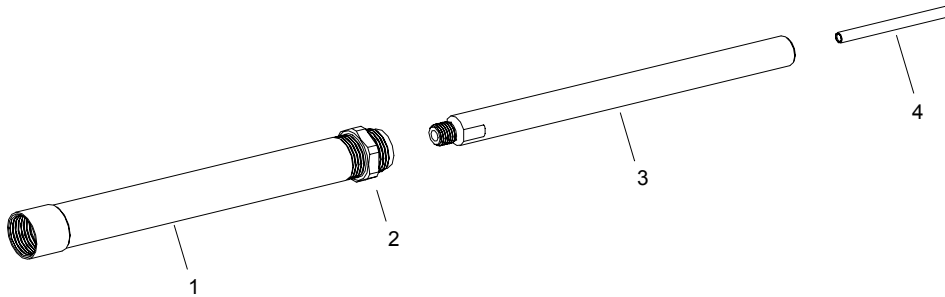

| Ref. | Description | Qty. | Part Number | | | |
|------|--------------------|------|-------------|---------|---------|---------------|
| | | | *704002 | *704004 | *704006 | *704006-2 |
| 1 | Sleeve Extension | 1 | 70416 | 70417 | 70418 | 70418 (2 ea.) |
| 2 | Nut | 1 | 70104 | 70104 | 70104 | 70104 (2 ea.) |
| 3 | Drawbolt Extension | 1 | 70420 | 70421 | 70422 | 70422 (2 ea.) |
| 4 | Tube | 1 | 70415 | 70415 | 70415 | 70415 (2 ea.) |

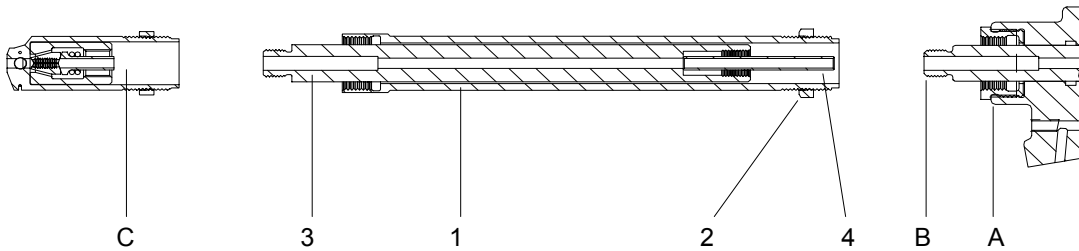

1. Insert tube (4) into head piston (B), to replace spring (C not shown) when extending a 456MAX-701-17 Nose Assembly.
2. Screw drawbolt extension (3) onto end of head piston (B). Tighten securely using wrenches and flats provided.
3. Thread sleeve extension (1) snugly into end of head cylinder (A) until thread bottoms out.
4. Tighten nut (2) securely.
5. Install nose assembly per instructions on appropriate data sheet.

*Extensions may be assembled together to achieve various lengths.

Rev. 11/08

GAGE BILT
MADE IN U.S.A.

GAGE BILT Inc.
44766 Centre Court (586) 226-1500
Clinton Twp., MI 48038 (586) 226-1505 Fax
e-mail:solutions@gagebilt.com / www.gagebilt.com