

NOSE ASSEMBLY DATA SHEET

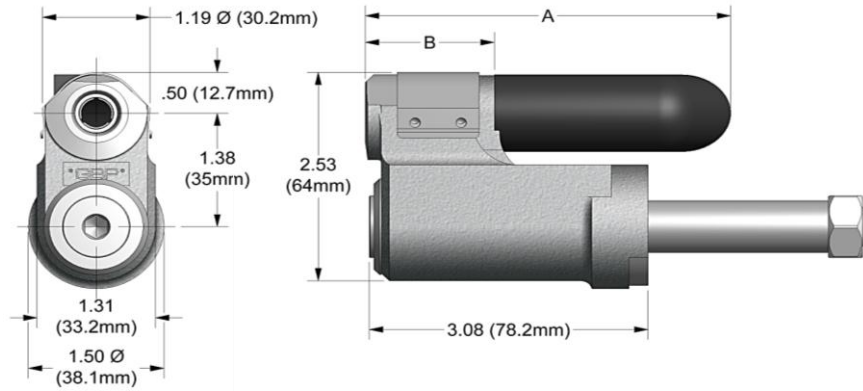

Nose Assy.	A	B
LGP10-	4.00 (101.6mm)	1.39 (35.3mm)
LGP12-	4.04 (102.6mm)	1.43 (36.3mm)

CAUTION:
Gage Bilt recommends rotating deflector 90 degrees away from operator to prevent pintails from dropping into slot. If collet strokes rearward with pintail in slot there is a risk of breakage.

WARNING:
DO NOT REMOVE
PINCH POINT

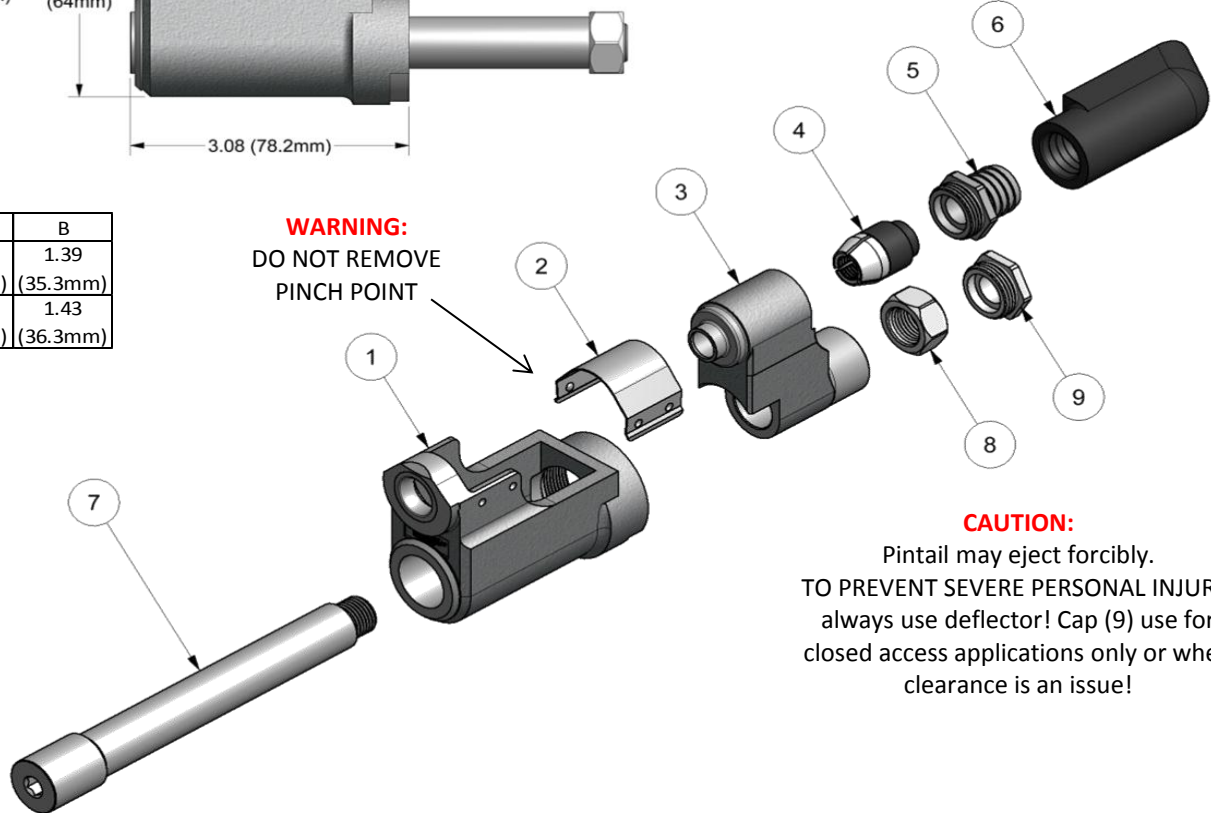

CAUTION:
Pintail may eject forcibly.
TO PREVENT SEVERE PERSONAL INJURY,
always use deflector! Cap (9) use for
closed access applications only or when
clearance is an issue!

ASSEMBLY INSTRUCTIONS:

Disconnect tool from power source. On front of GB205 Installation tool, remove screw and stop. With collet placed in anvil install on tool. Apply Vibra-TITE® part no. 405124 to threads on drawbar. Slide drawbar thru anvil and collet. Screw nut "counterbore in" on rear of drawbar. Connect tool to power source. Cycle the tool to rear position. While holding the trigger down, disconnect tool from power source. Using a 1/4" hex wrench and a 1/2" socket wrench, tighten nut on the drawbar. Replace screw and stop on tool.



REV. 12/13

*Use Adapter No. 353205 with 756153 stroke limiter.
**Use Adapter No. 353205 with 258153 stroke limiter & 258156 Relief Valve.

GAGE BILT

GAGE BILT Inc.

44766 Centre Court (586) 226-1500
Clinton Twp. MI 48038 (586) 226-1505 Fax
e-mail:solutions@gagebilt.com / www.gagebilt.com

Type:		Fasteners:	Recommended Tool: GB205	
Non Self-Releasing 5/16" & 3/8" Ø		LGP® Lockbolts	Alternate Tools: *GB756 and **GB2581	
Ref. No.	Qty.	Description	LGP10-205A-31	LGP12-205A-31
1	1	Anvil Assembly	11073	11229
2	1	Guard	61012	61012
3	1	Collet	21022	21229
4	1	Super-Grip Jaw Assembly	31028-S1	31226-S3
5	1	Barbed Retainer	61105	61105
6	1	Deflector	752122	752122
7	1	Drawbar	71109	71109
8	1	Nut	71110	71110
9	1	Cap	61101	61101