

NOSE ASSEMBLY DATA SHEET

CAUTION:
Pintail may eject forcibly. USE DEFLECTOR TO PREVENT SEVERE PERSONAL INJURY. Cap (9) use for closed access applications only or when clearance is an issue!

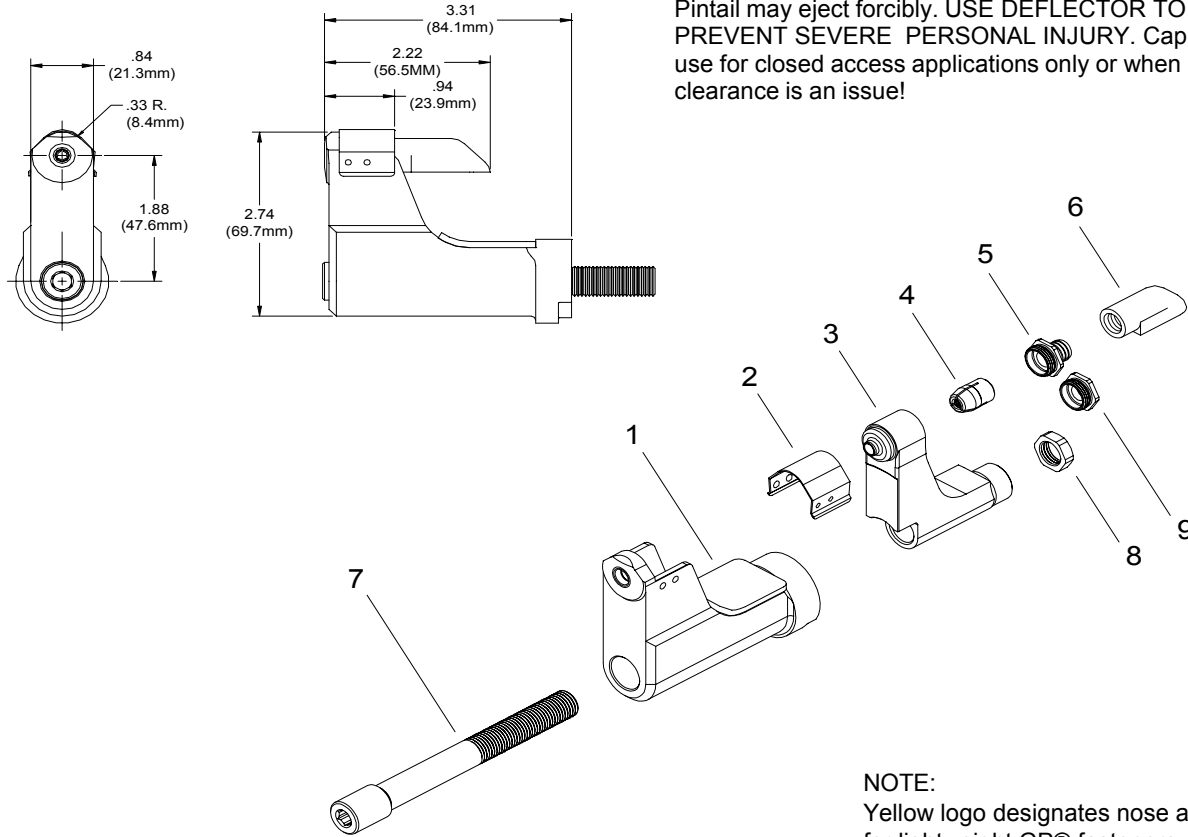

NOTE:
Yellow logo designates nose assy's for lightweight GP® fasteners.

ASSEMBLY INSTRUCTIONS:

On front of GB206A-375 Installation Tool remove screw and stop. With collet placed in anvil, install on tool. Slide drawbar thru anvil and collet. Screw draw bar into piston until it stops. Attach nut on rear of draw bar. Replace screw and stop on tool.



Rev. 2/11

*Use Adapter No. 751206.
**Use Adapter No. 353206.

GAGE BILT

GAGE BILT Inc.

44766 Centre Court (586) 226-1500
Clinton Twp., MI 48038 (586) 226-1505 Fax
e-mail:solutions@gagebilt.com / www.gagebilt.com

Type:		Fasteners:		Recommended Tool: GB206A-375	
Non Self-Releasing 5/32", 3/16" & 1/4" Ø		LGP® Lockbolt		Alternate Tools: *GB731 & **GB745	
Ref. No.	Qty.	Description	LGP05-206F-34OS	LGP06-206F-34OS	LGP08-206F-34OS
1	1	Anvil	15543	16639	18832
2	1	Guard	60426	60426	60426
3	1	Collet	20554-1	20673-1	20890-1
4	1	Super-Grip Jaw Assembly	30543-S9	30654-S9	30862-S5
5	1	Barbed Retainer	70569	70569	70569
6	1	Deflector	61107	61107	61107
7	1	Drawbar	71121	71121	71121
8	1	Nut	70546	70546	70546
9	1	Cap	70571	70571	70571