

NOSE ASSEMBLY DATA SHEET

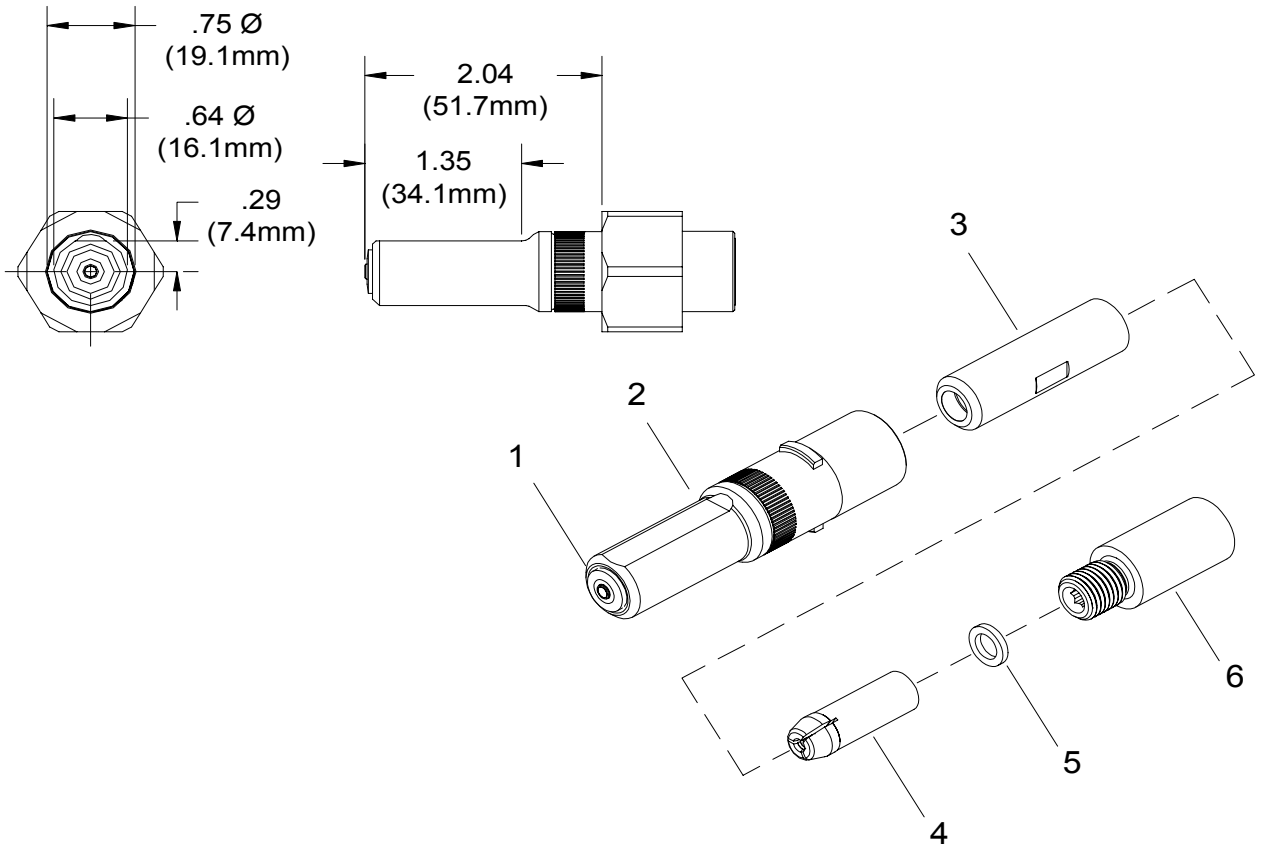

Use Hex-Key in rear of piston for nose assembly attachment.

Use Hex-Key in rear of collet extension for collet disassembly.



*Anvil Assembly consists of #1 and 35208 retainer.

1/12

GAGE BILT

GAGE BILT Inc.

44766 Centre Court (586) 226-1500
 Clinton Twp., MI 48038 (586) 226-1505 Fax
 e-mail:solutions@gagebilt.com / www.gagebilt.com

Type:		Fastener:		Recommended Tool:	
Non Self-Releasing 1/8, 5/32 & 3/16 \varnothing		NAS1719, NAS1720 NAS1721 MBC®		GB752	
				Alternate Tools: GB730 & GB2480	
Ref. No.	Qty.	Description	MBC04-752C-20	MBC05-752C-20	MBC06-752C-20
1	1	Anvil-Driving	10259	10260	10261
2	1	Anvil & Holder Assy.	17775	17776	17777
3	1	Collet	20727	20727	20727
4	1	Super-Grip Jaw Assembly	30425-CS	30545-CS	30656-CS
5	1	Spacer	70572	70572	70572
6	1	Collet Extension	70550	70550	70550