

# NOSE ASSEMBLY DATA SHEET

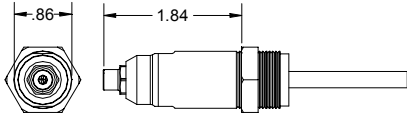

## COUNTERSUNK AND PROTRUDING HEAD SELECTION CHART

RIVET	DIAMETER	NOSE ASSEMBLY	NOSE TIP	FOLLOWER
N, Q & E, POP®, CLOSED END, AVEX®, MAGNA-LOK®, MAGNA-BULB, HEMLOK®, BULB-TITE® (NON-STRUCTURAL) & ULTRA-GRIP COMMERCIAL RIVETS	3/32 1/8 5/32 3/16	3N-703-18V 4N-703-18V 5N-703-18V 6N-703-18V	10201 10202 10203 10204	703421 703421 703415 703415
T RIVET®	3/16	6T-703-18V	10209	703415
NUT PLATE RIVETS CCR244/264/274 BACR15DR MS20600	3/32 1/8	3NP-703-18V 5N-703-18V	10231 10203	703415 703415
MONOBOLT®	3/16	MB06-703-18V	10210	703415
KLAMPTITE® RIVET	3/16	6KT-703-18V	10263	703415
MACHINE SCREW	5mm	MS5M-703-18V	10332	703415

## PROTRUDING HEAD SELECTION CHART

RIVET	DIAMETER	NOSE ASSEMBLY	NOSE TIP	FOLLOWER
N, Q & E, POP®, CLOSED END, AVEX®, MAGNA-LOK®, MAGNA-BULB, HEMLOK®, BULB-TITE® (NON-STRUCTURAL) & ULTRA-GRIP COMMERCIAL RIVETS	3/16	MGL06-703-18V	10248	703415

POP® IS A REGISTERED TRADEMARK OF BLACK & DECKER CO.  
 MAGNA-LOK® IS A REGISTERED TRADEMARK OF HUCK INTERNATIONAL INC.  
 AVEX®, T RIVET®, KLAMPTITE®, HEMLOK® & MONOBOLT® ARE REGISTERED TRADEMARKS OF AVDEL/CHERRY  
 TEXTRON.  
 BULB-TITE® IS A REGISTERED TRADEMARK OF GESIPA.

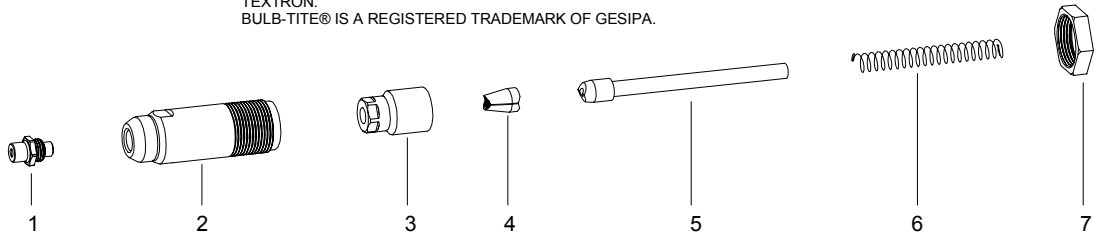

8/99 Rev. 9/07

**GAGE BILT**  
MADE IN U.S.A.

**GAGE BILT PRODUCTS CORP.**  
 14500 Barber Drive (586) 771-7664  
 Warren, Mi 48088 (586) 771-2665 Fax  
 e-mail: solutions@gagebilt.com / www.gagebilt.com

Type:	Fastener:	Recommended Tool:
Self-Releasing	See Chart	GBP703B & GBP743A

Ref. No.	Qty.	Description	XX-703-18V
1	1	Nose Tip	See Chart
2	1	Anvil-Holder	10757
3	1	Collet	20518
4	1	Jaw Set (2 pcs.)	30617
5	1	Follower	See Chart
6	1	Spring	405371
7	1	Jam Nut	70820