

NOSE ASSEMBLY DATA SHEET

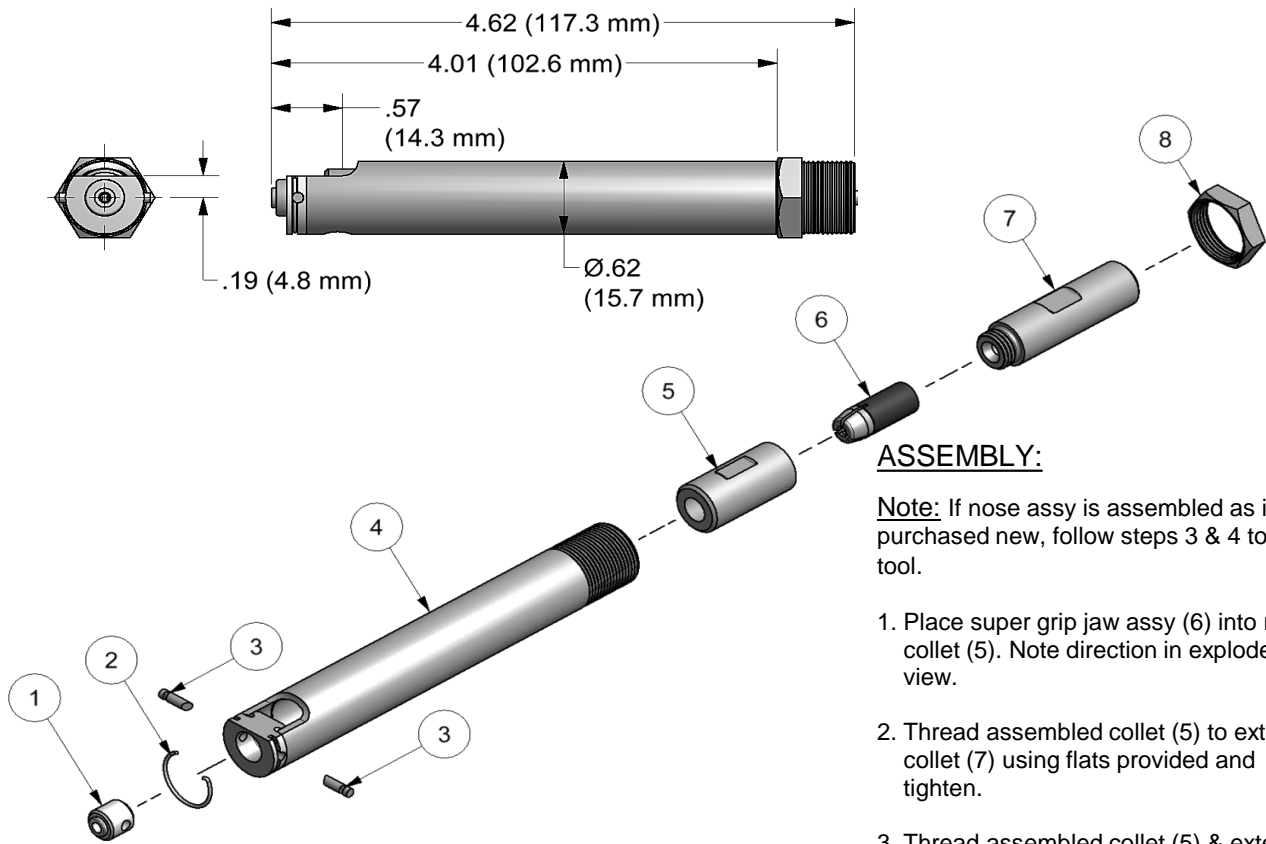

ASSEMBLY:

Note: If nose assy is assembled as it is when purchased new, follow steps 3 & 4 to attach to tool.

1. Place super grip jaw assy (6) into rear of collet (5). Note direction in exploded view.
2. Thread assembled collet (5) to extension collet (7) using flats provided and tighten.
3. Thread assembled collet (5) & extension-collet (7) to piston on tool.
4. Slide anvil & holder assy (4) over assembled collet (5) and extension-collet (7) and thread into tool. Tighten jam nut (8) to face of tool.

DISASSEMBLY:

Reverse assembly instructions.



12/13 REV. 6/18

GAGE BILT
MADE in USA

44766 Centre Court Clinton Twp. MI 48038 USA
Ph: +1 (586) 226-1500 Fax: +1 (586) 226-1505
solutions@gagebilt.com / www.gagebilt.com

Type: Single Action Non Self-Releasing		Fasteners: NUT PLATE RIVETS MS20600 SERIES CCR224/264/274 MS/9SP/PT BACR15CC/CF/DA/DR	Recommended Tool: GB55B
5/32" Ø			
Ref. No.	Qty.	Description	5C-54-43
1	1	Anvil Insert	10385
2	1	Retaining Ring	50302
3	2	Ratchet Pin	15501
4	1	Anvil & Holder Assy	13499
5	1	Collet	20332
6	1	Super Grip Jaw Assy	30529-S
7	1	Drawbolt	70342
8	1	Jam Nut	70411