

NOSE ASSEMBLY DATA SHEET

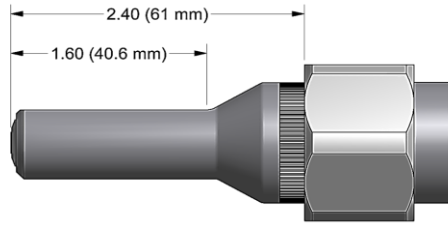
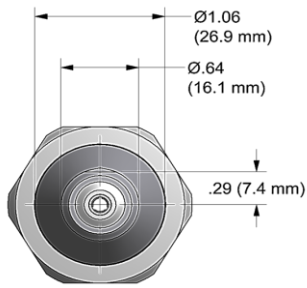

ASSEMBLY:

Note: If nose assy is assembled as it is when purchased new, follow steps 3-5 to attach to tool.

1. Insert super grip jaw assy (4) into rear of collet (3). (Note direction in exploded view).
2. Thread collet (3) to extension-collet (6) using flats provided.
3. Thread assembled collet (3) and extension-collet (6) onto piston of tool using flats provided and hex in rear of piston.
4. Slide anvil & holder assy (2) over collet (3).
5. Slide retaining nut stop and retaining nut over ears on anvil (see exploded view) and tighten to tool.

DISASSEMBLY:

Reverse assembly instructions.

SLOTS ON RETAINING NUT STOP, SUPPLIED WITH TOOL, FIT OVER EARS ON ANVIL ASSY

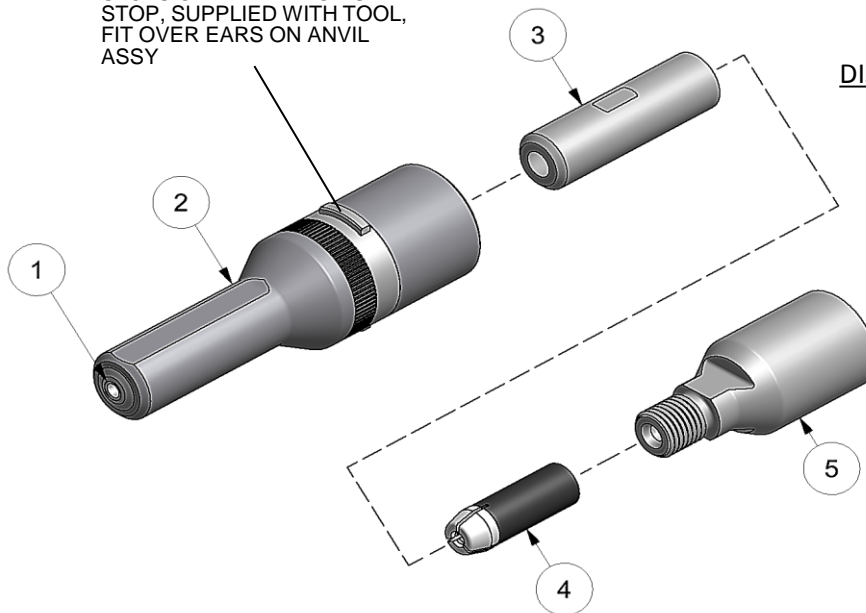

8/03 REV 1/18

GAGE BILT
MADE in USA

44766 Centre Court Clinton Twp. MI 48038 USA
Ph: +1 (586) 226-1500 Fax: +1 (586) 226-1505
solutions@gagebilt.com / www.gagebilt.com

| Type: | | Fastener: | Recommended Tool: GB745 |
|-------------------------------|------|---|---------------------------------------|
| Non Self-Releasing 3/16" Ø | | NAS1398A/NAS1399A RV1000/RV1100 & RV1200 | Alternate Tools: GB756 & GB2581(A) |
| Ref. No. | Qty. | Description | 6A-745B-23 |
| 1 | 1 | Anvil Insert | 16028 |
| 2 | 1 | Anvil Assy (Inc. #1) | 13304 |
| 3 | 1 | Collet | 20717 |
| 4 | 1 | Super-Grip Jaw Assy | 30656-S |
| 5 | 1 | Extension-Collet | 70552 |