

NOSE ASSEMBLY DATA SHEET

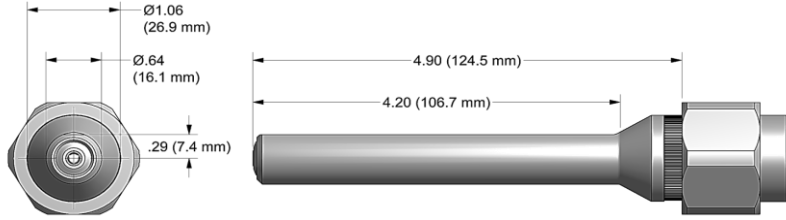

ASSEMBLY:

Note: If nose assy is assembled as it is when purchased new, follow steps 3-5 to attach to tool.

1. Insert super grip jaw assy (4) into rear of collet (3). (Note direction in exploded view).
2. Thread collet (3) to extension-collet (6) using flats provided.
3. Thread assembled collet (3) and extension-collet (6) onto piston of tool using flats provided and hex in rear of piston.
4. Slide anvil & holder assy (2) over collet (3).
5. Slide retaining nut stop and retaining nut over ears on anvil (see exploded view) and tighten to tool.

DISASSEMBLY:

Reverse assembly instructions.

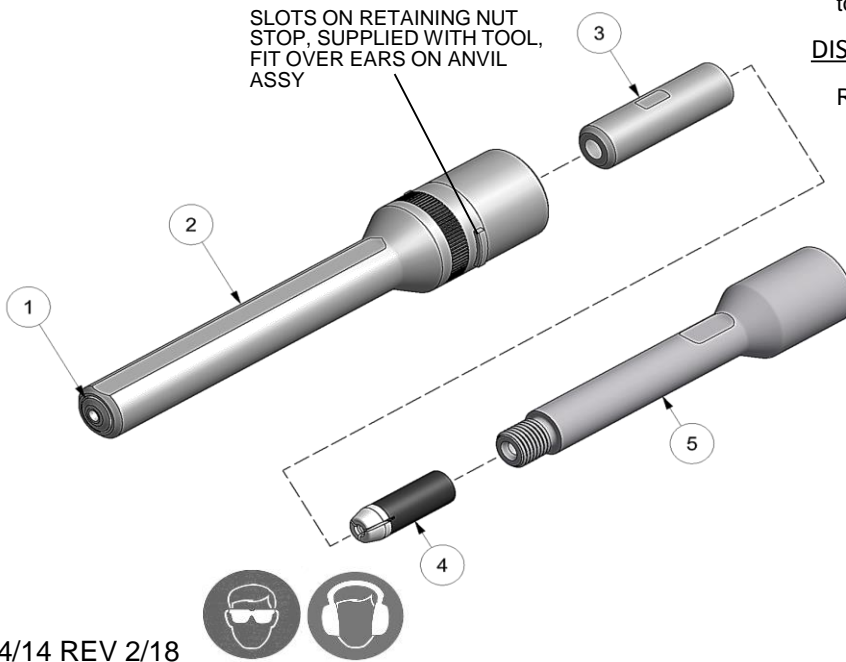

4/14 REV 2/18

GAGE BILT
MADE in USA

44766 Centre Court Clinton Twp. MI 48038 USA
Ph: +1 (586) 226-1500 Fax: +1 (586) 226-1505
solutions@gagebilt.com / www.gagebilt.com

Type:		Fastener:	Recommended Tool: GB745
Non Self-Releasing 3/16" Ø		NAS1398A/NAS1399A RV1000/RV1100 & RV1200	Alternate Tools: GB756 & GB2581(A)
Ref. No.	Qty.	Description	6A-745B-48
1	1	Anvil Insert	16028
2	1	Anvil Assy (Inc. #1)	13345
3	1	Collet	20717
4	1	Super-Grip Jaw Assy	30656-S
5	1	Extension-Collet	70553